

DIN 929 Stahl

Schweissmutter Sechskant

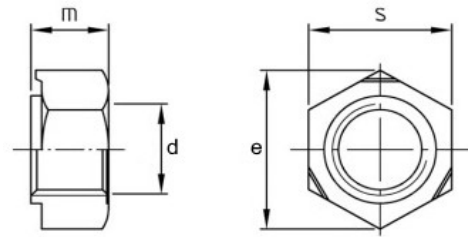

Maße (d)	M 3	M 4	M 5	M 6	M 8	M 10	M 12	M 16			
<b>m</b>	3	3,5	4	5	6,5	8	10	13			
<b>e</b>	8,15	9,83	10,95	12,02	15,38	18,74	20,92	26,51			
<b>SW (s)</b>	7,5	9	10	11	14	17	19	24			

Maße in mm